

SERIES 1117 - SNAP-ACTION SWITCHES

TO 16 (6) A 400 V AC





PRODUCT FEATURES

- ◆ Double interrupting jump contact switching system
- ◆ Contact distance > 3 mm
- ◆ Material conformant with the filament wire test acc. to IEC 60 335-1:2001 chap. 30 and UL 94 V-0
- ◆ Large overtravel
- ◆ Actuator can be approached from all directions
- ◆ Normally open contact and normally closed contact versions

ON REQUEST

- ◆ Customized versions



Mechanical life endurance	10E4
Contact resistance (new condition)	< 100 mOhm (1 A 12 V DC)
Insulation resistance (new condition)	> 100 MOhm (500 V DC)
Voltage strength at 250 V	1 500 V function insulation / basic insulation 3 000 V reinforced insulation (depending on installation situation)
Proof tracking	250 PTI
Insulation spacing	acc. to EN 61058 for reinforced or double insulation
Protection type	IP 40
Ambient temperature	-40 °C ... +85 °C
Flammability	UL 94 V-0
Heat and fire resistance	850 °C (category D)
Material	actuator PA glass fiber-reinforced housing PA glass fiber-reinforced connections silver-plated
Contact material	Ag
Contact distance	≥ 3 mm
Approval marks	 /  / 

Suitable for appliances of protection class II under compliance with the installation conditions required on the equipment side



SERIES 1117 - SNAP-ACTION SWITCHES

TO 16 (6) A 400 V AC

	16 (6) A 400 V AC 1E4	12 A 250 V AC 1/2 HP	12 A 125 V AC 1/6 HP	Connection type	Connection description	Contact distance in mm	Operating force in N	Operating position (OP) in mm	Difference travel max. in mm	Free position (FP) max. in mm	Permissible total travel position (TP) in mm	Stock version
Normally closed contact (SPNC)												
1117.0206	●	●	●		6.3	≈ 3	3.5 ± 0.5	12.4 ± 0.5	2.6	15.2	8.5	●
Normally open contact (SPNO)												
1117.0106	●	●	●		6.3	≈ 3	3.5 ± 0.5	12.4 ± 0.5	2.6	15.2	8.5	●



Basic type 1117

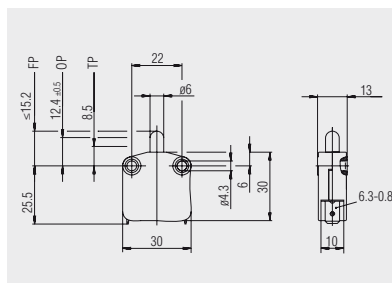

 Quick-connect terminal 6.3

PRECISION SALES INC
 38 Bishop Hollow Rd
 Newtown Square PA 19073
www.precisionales.com
eparts@precisionales.com
 Fax : 610-353-1674
 610-359-1002

ROCKER SWITCHES

PUSHBUTTON SWITCHES

TOGGLE SWITCHES

SLIDE SWITCHES

ROTARY SWITCHES

FOOT SWITCHES

POWER TOOL SWITCHES

KEY SWITCHES